

11-1 S.M.P .S/POWER

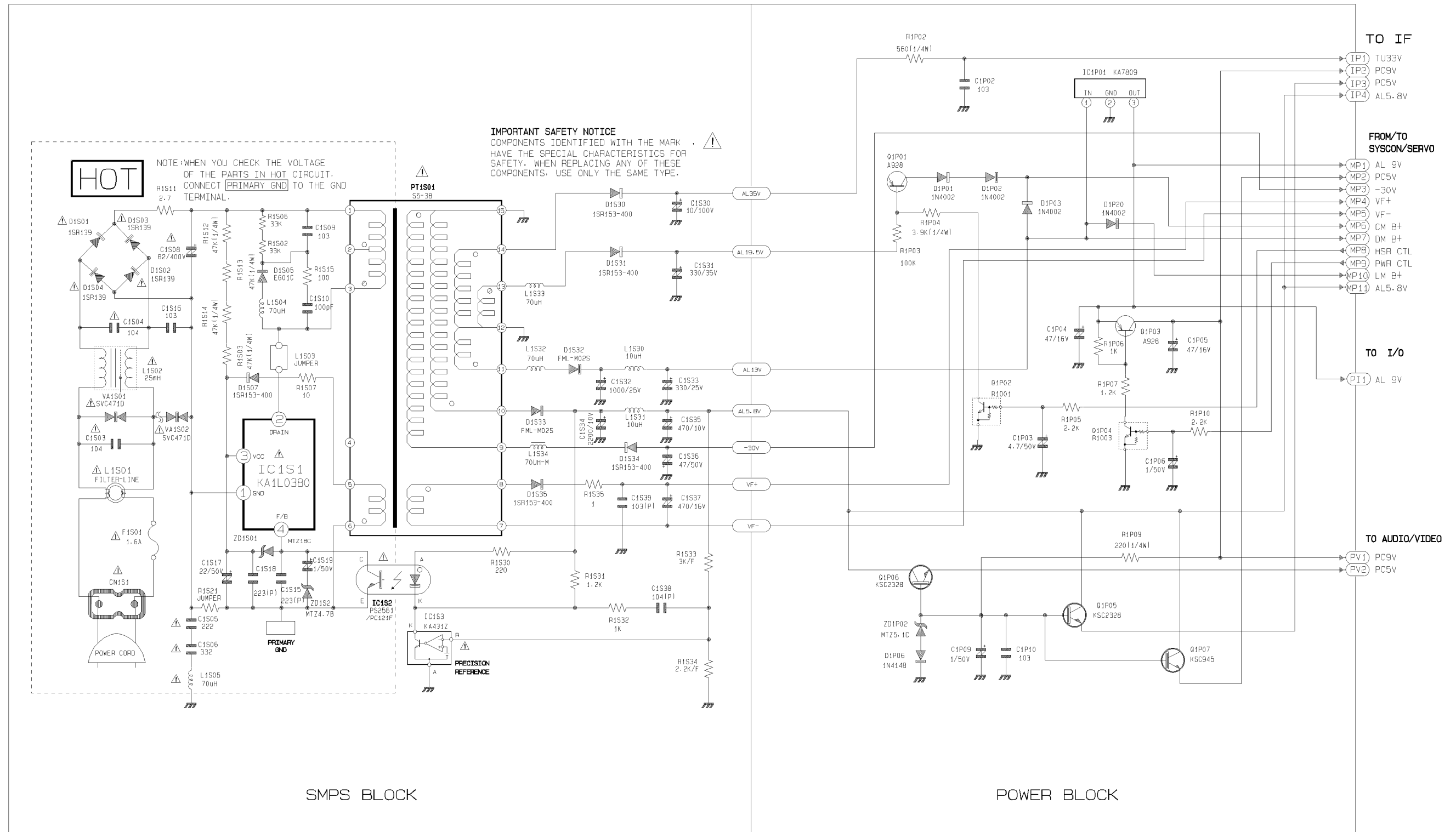

11-2 System Contr ol/Ser vo

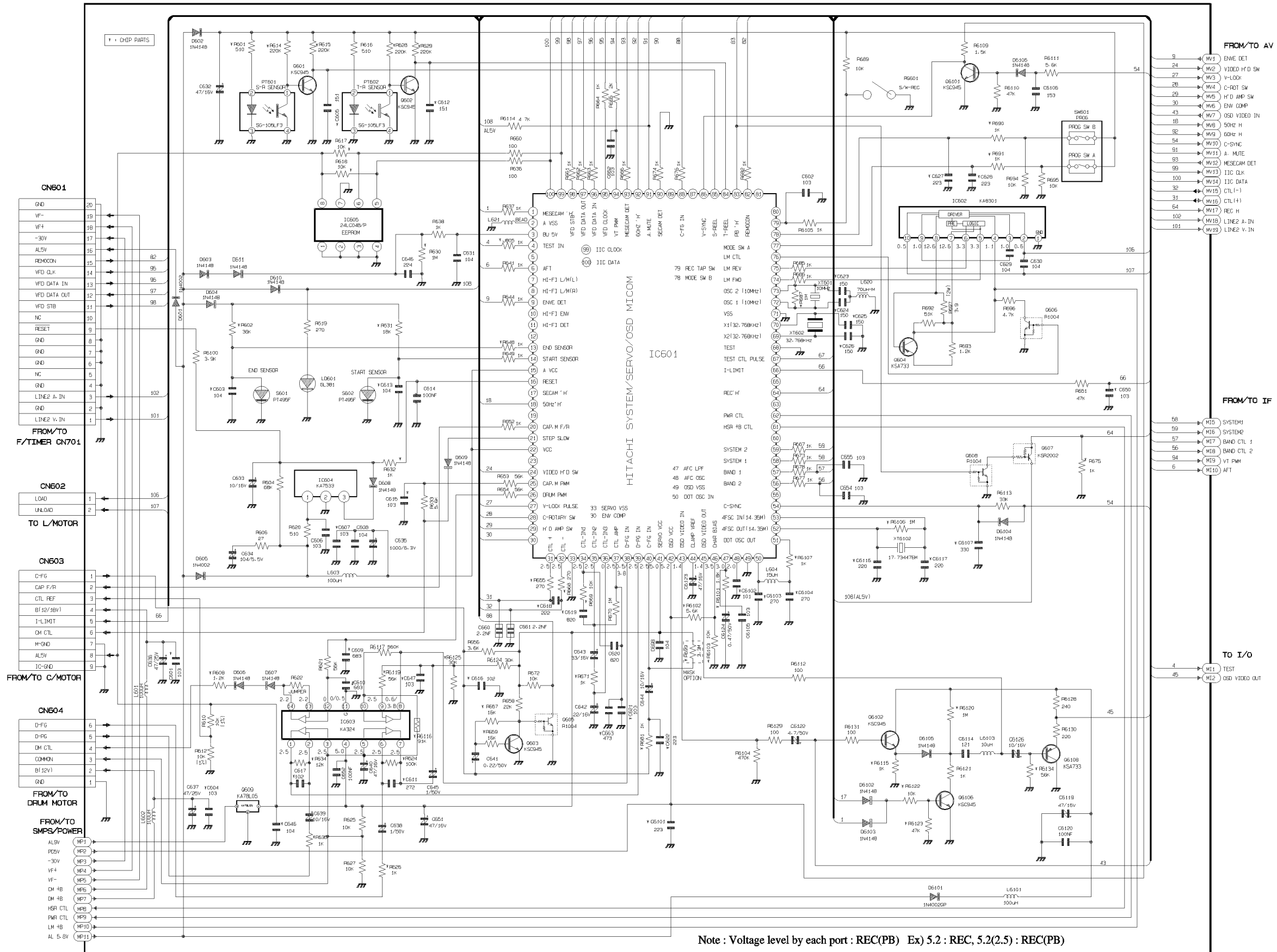

11-3 Audio/V ideo(2 Heads)

———— REC Y PROCESS
 - - - - - REC C PROCESS

———— PB Y PROCESS
 - - - - - PB C PROCESS

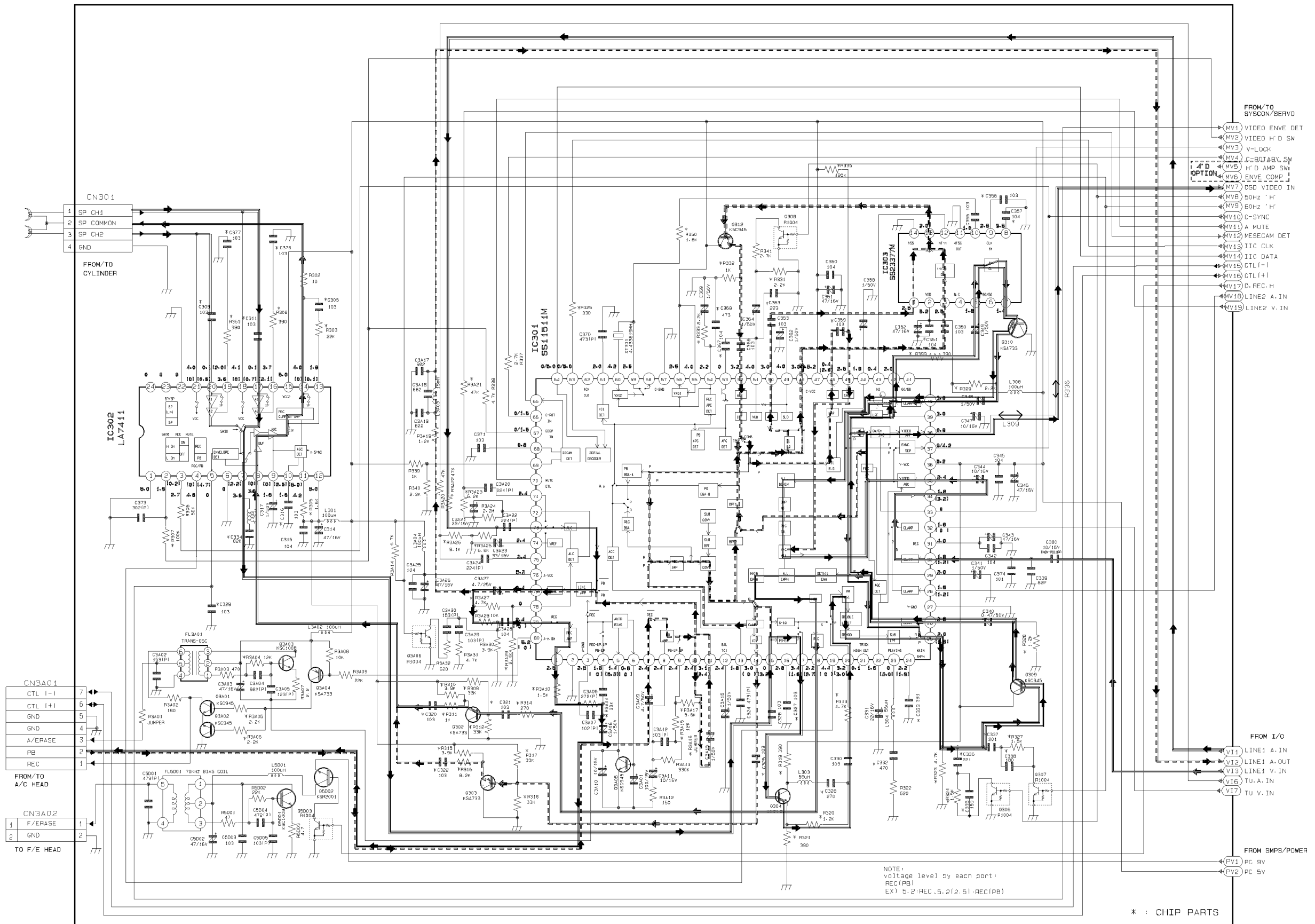

NOTE:
 voltage level by each port:
 REC(PB)
 EX) 5.2 REC. 5.2(2.5) REC(PB)

* : CHIP PARTS

11-4 Audio/V ideo(4 Heads)

REC Y PROCESS PB Y PROCESS
 REC C PROCESS PB C PROCESS

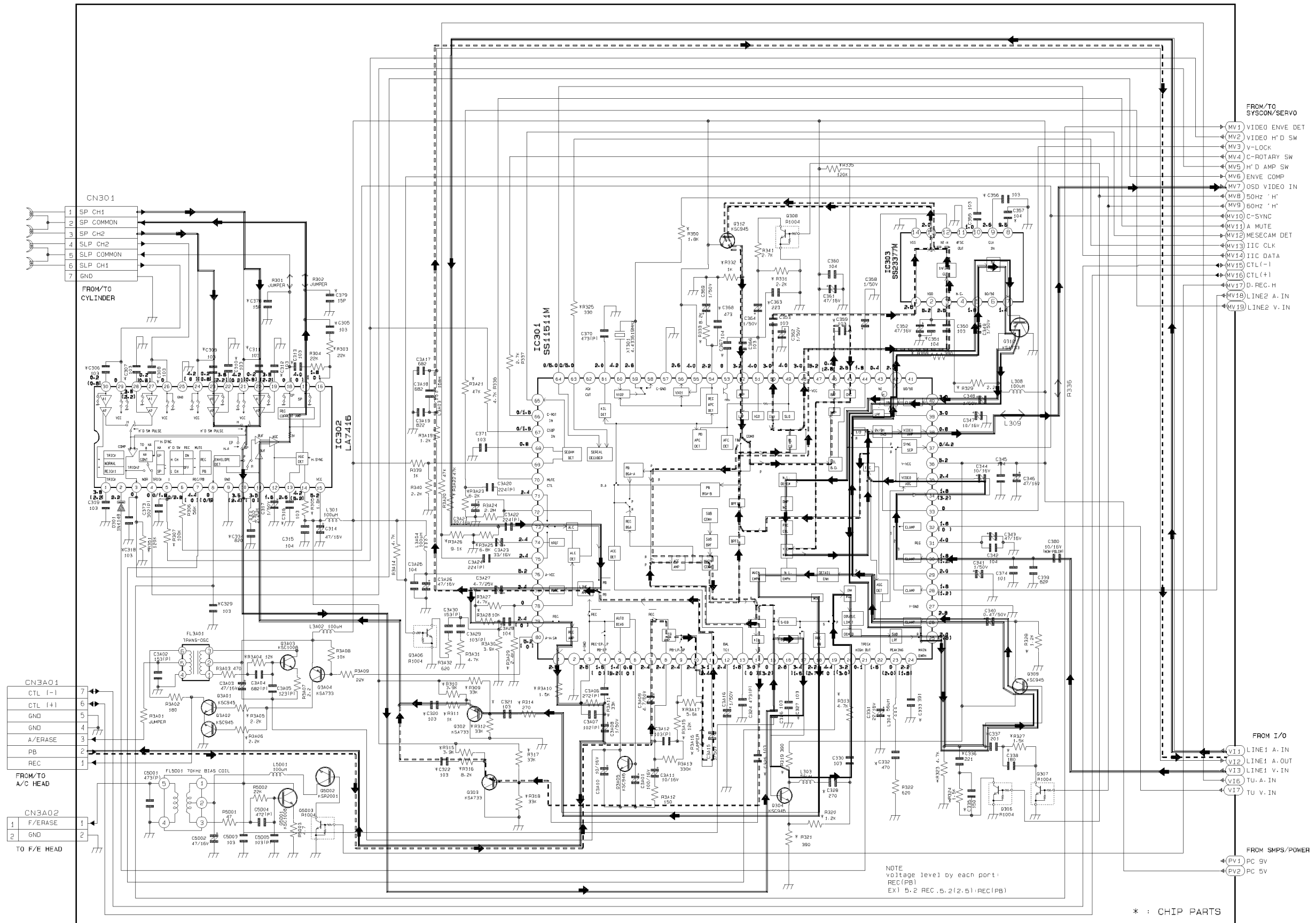

11-5 Audio/V ideo(2 Heads Multi)

————— REC Y PROCESS
 - - - - - REC C PROCESS

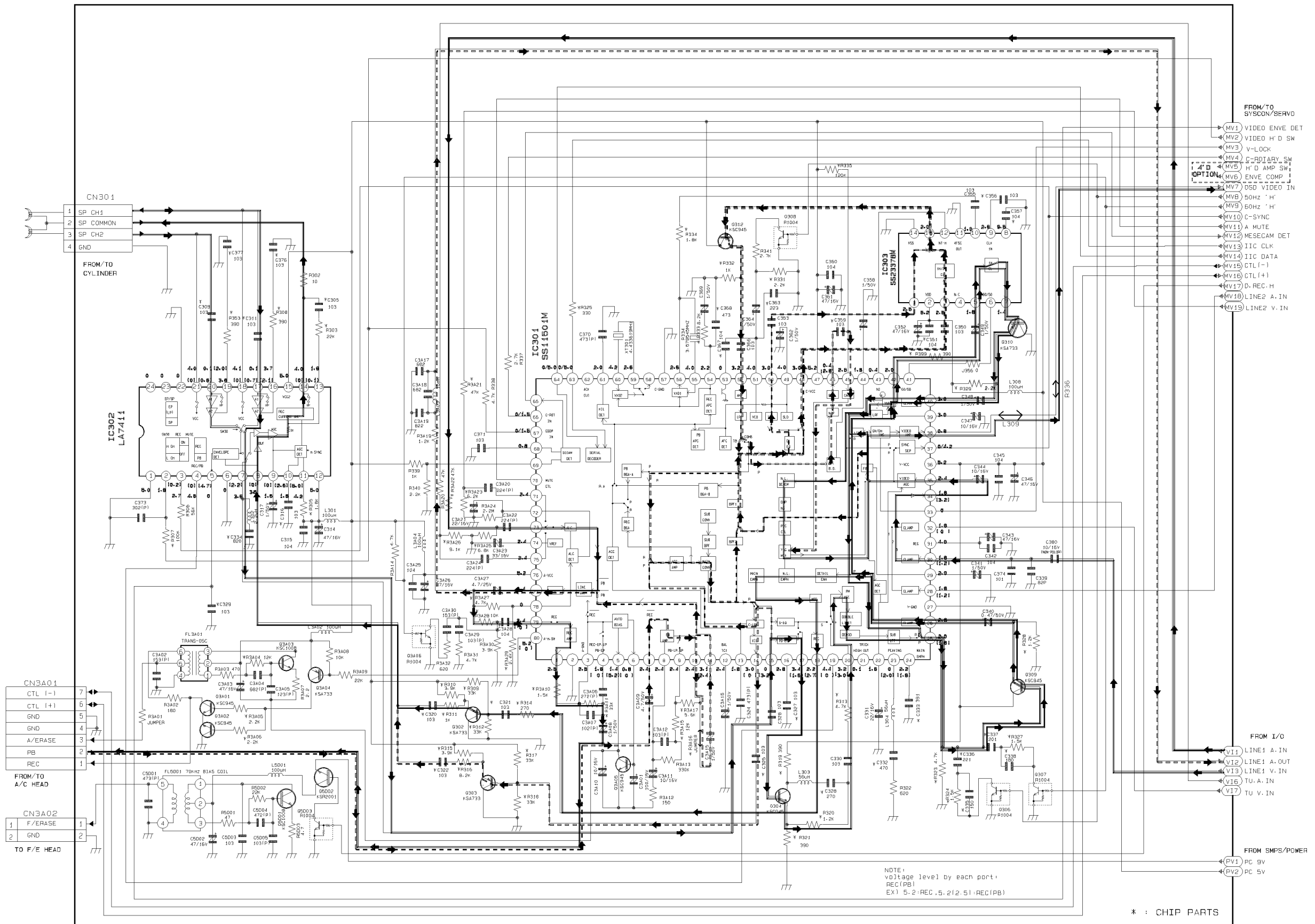

11-6 Audio/Video(4 Heads Multi)

— REC Y PROCESS
 - - - - - REC C PROCESS

— PB Y PROCESS
 - - - - - PB C PROCESS

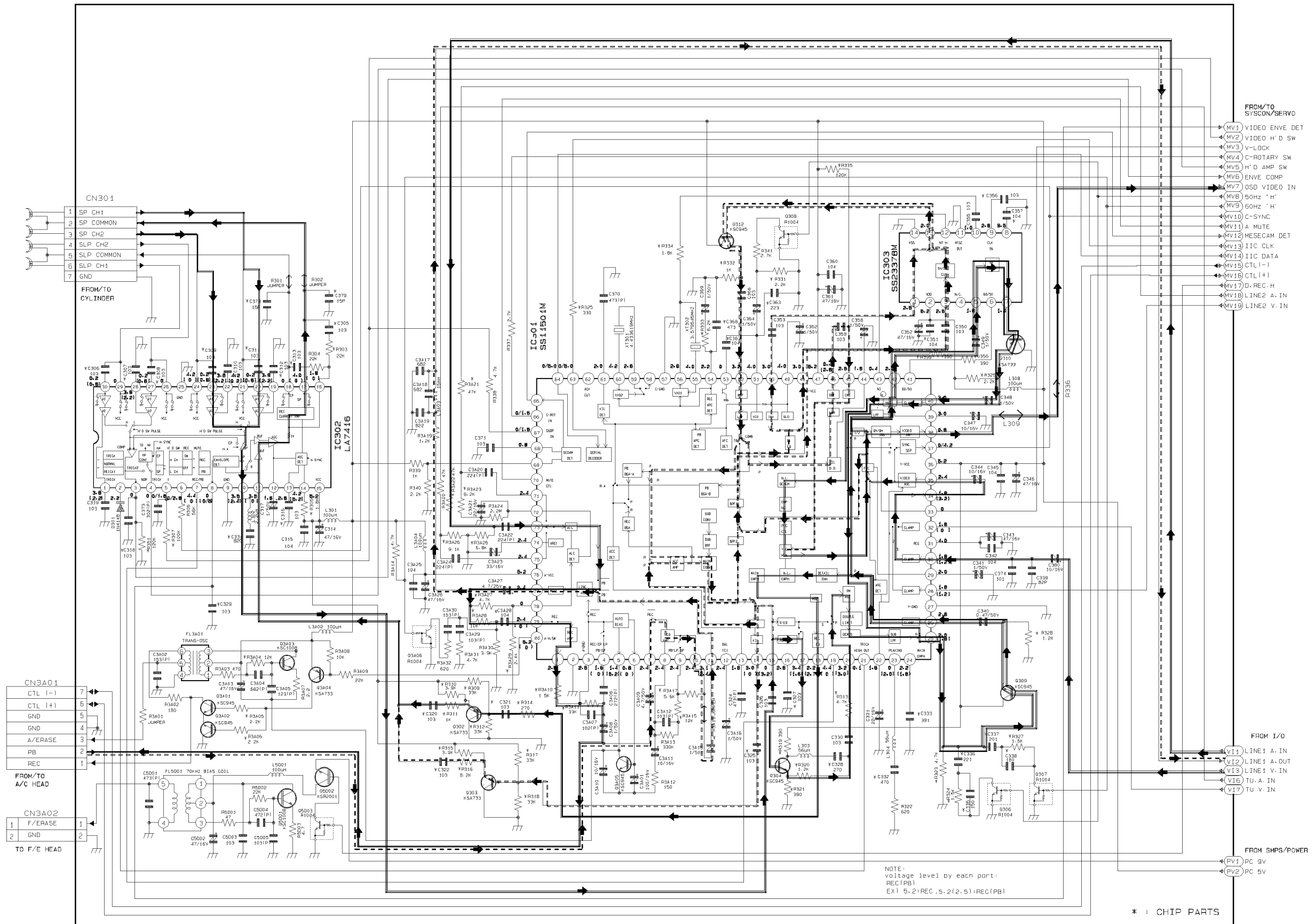

NOTE:
 voltage level by each part:
 REC(PB)
 EX1 5.2 REC 5.2(2.5) REC(PB)

* : CHIP PARTS

11-7 IF

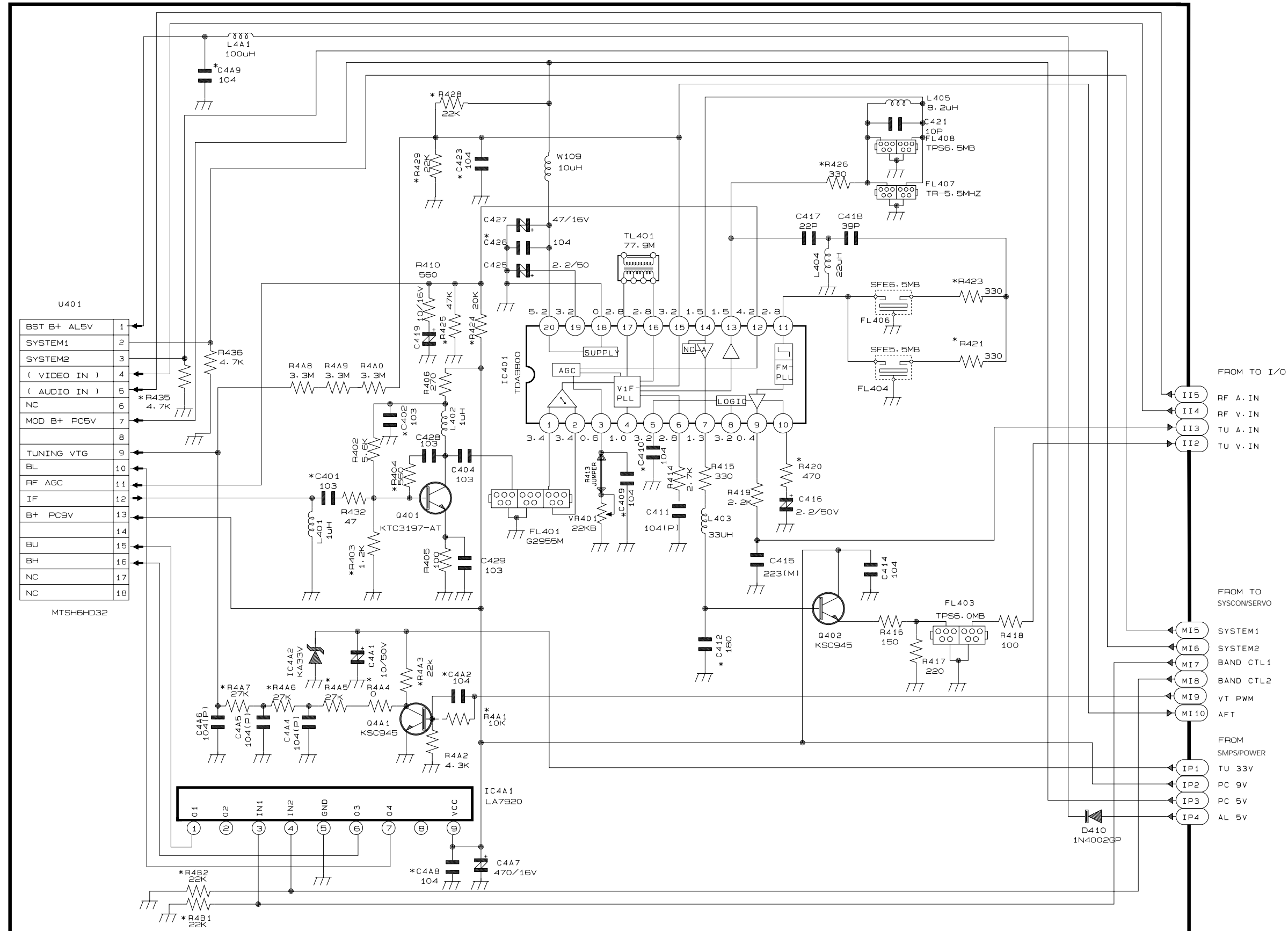

11-8 I/O

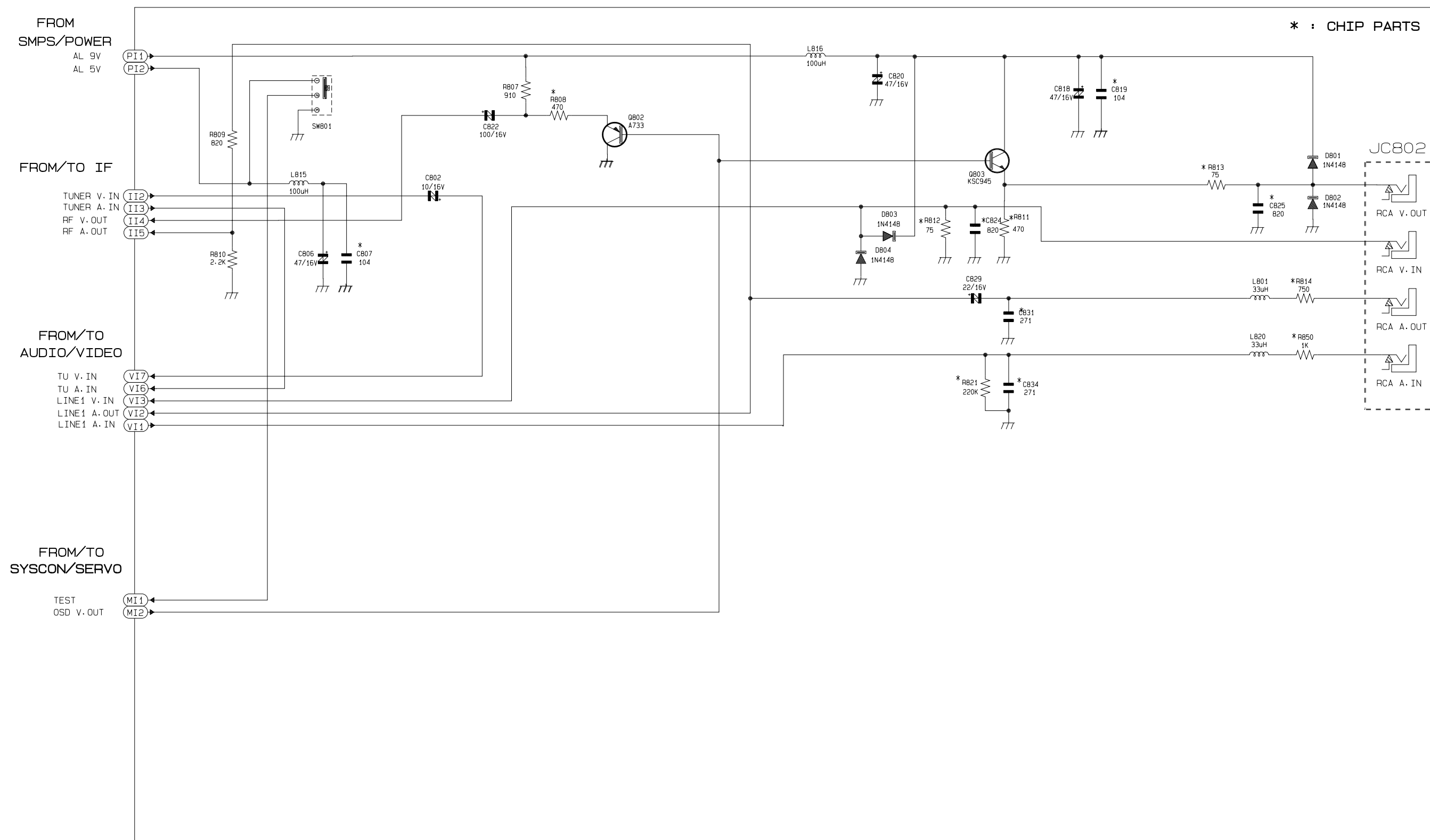

11-9 Function-Timer(SV -A20G/A30G/A60G/SVR-200/400)

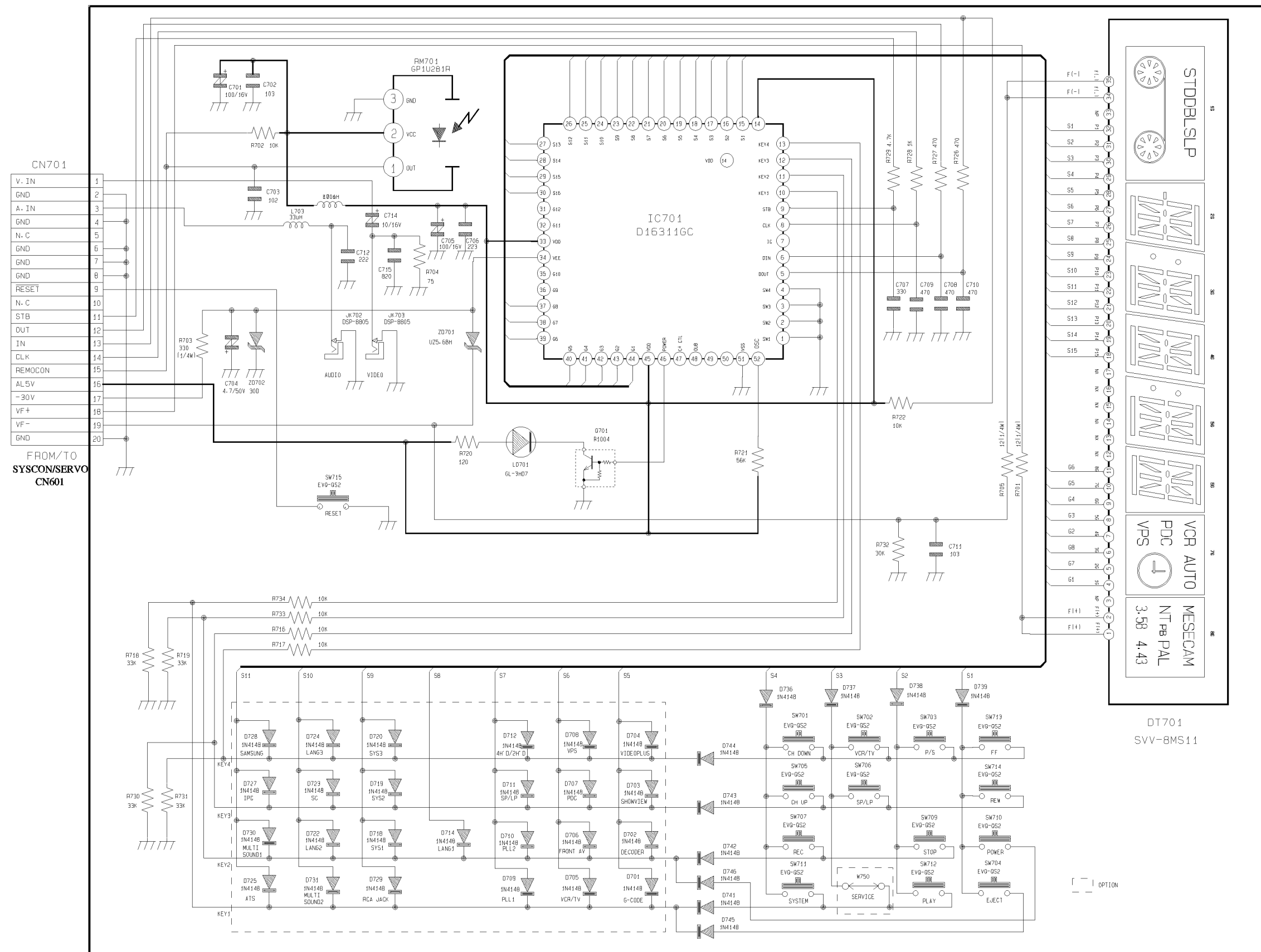

11-10 Function-Timer (SV -A40G/A80G/SVR-205/405)

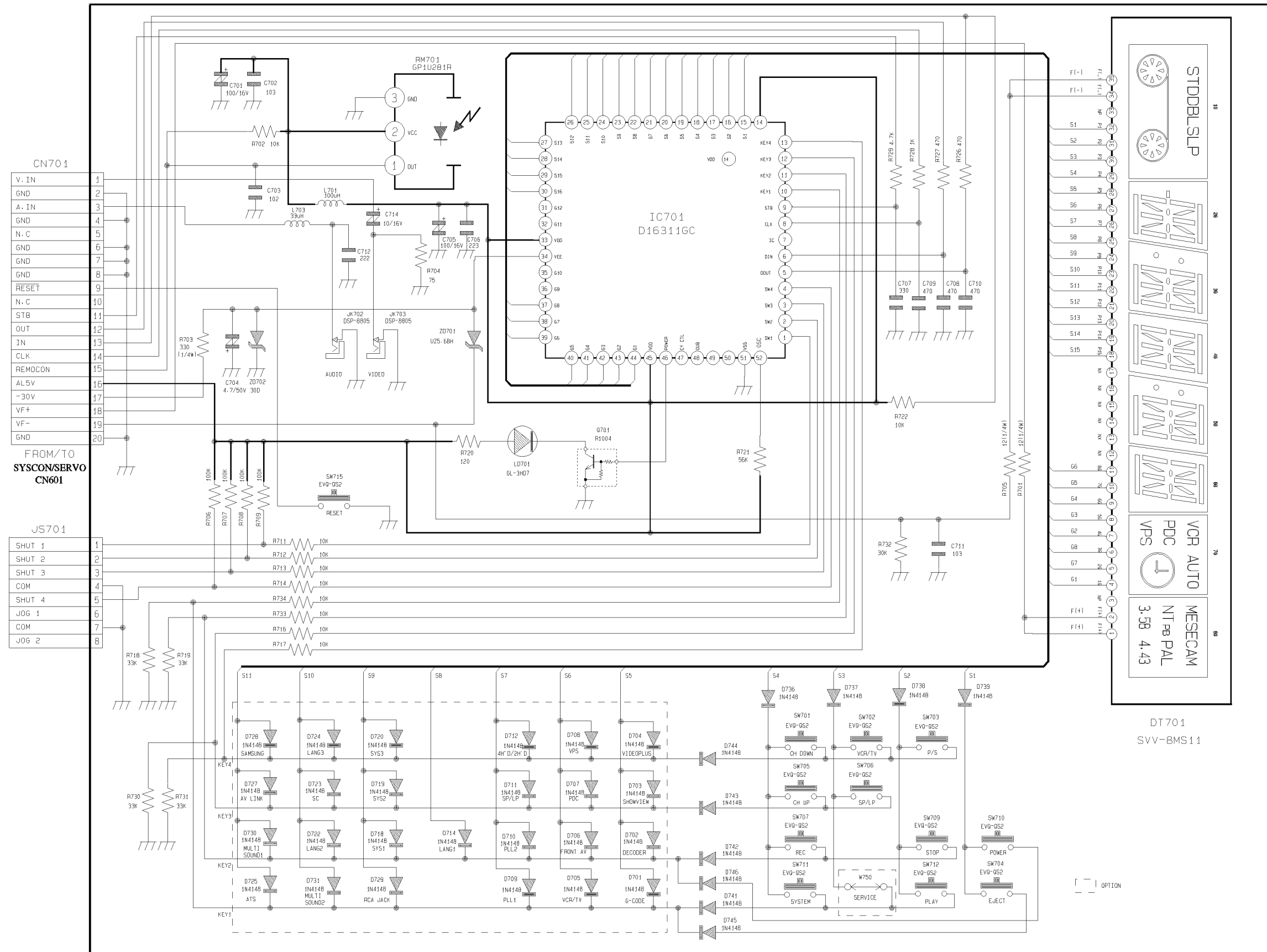

11-11 Remote-Control

